



# EASY 4 STEP OPERATION

1



Scan the barcode on the cartridge box

2



Insert cartridge, remove the foil and press reagent bead into the cartridge.

3



Take blood sample. Insert into cartridge and snap the stick.

4



Close lid. Results in 4 minutes.

## TECHNICAL SPECIFICATIONS

| ANALYZER             |  |
|----------------------|--|
| Size                 | 95 mm(h) x 205 mm(w) x 135 mm(d)   |
| Weight               | 0.7 kg   |
| Display              | Blue LCD backlit monochrome display 128x64 pixels. Visible area 70x39mm  |
| Connections          | USB 2.0 (slave), Printer(RS232), Barcode Scanner(PS2)  |
| Data Memory Capacity | 7,000 data records   |
| POWER SUPPLY         |  |
| Mains Adapter        | Separate AC to DC mains adapter  |
| Input                | 100-240 V AC, 50-60 Hz, 30 W   |
| Output               | 24 V DC, 1.25A   |
| BATTERY              |  |
| Type                 | CR1225, Lithium, non-rechargeable / non-replaceable.<br>Used to maintain the date, time and memory of the analyzer |
| OPERATING CONDITIONS |  |
| Temperature          | 18 to 30 °C (64 to 86 °F) or according to Test cartridge temperature range   |
| Relative Humidity    | 10 to 80 %, non condensing   |
| Location             | Clean, dry, horizontal surface and away from direct sunlight   |
| STORAGE & TRANSPORT  |  |
| Temperature          | -20 to 50 °C (-4 to 122 °F)  |
| Relative Humidity    | 10 to 93 % at 40 °C (104 °F)   |



For more information contact:

022 3204 3204 | customersupport@arkray.co.in

ARKRAY Healthcare Pvt. Ltd. 701-702, Opulence, 6th Road, TPS III, Santacruz (E), Mumbai - 400055, Maharashtra, India.



Accurate & Hassle-free HbA1c testing now possible

# Introducing PocketChem™ A1c HbA1c Analyzer



arkray healthcare Pvt. Ltd.  
www.arkray.co.in

## ACCURATE RESULTS

- ◆ **Boronate Fluorescent Quenching (BFQ) Technology**
  - Patented Technology
  - Unaffected by most Hb variants
- ◆ **NGSP Certified**
  - Globally standardized results traceable to IFCC reference method
- ◆ **CV < 3%**
- ◆ **Lot identification via Barcode reader**
  - Matches Lot with Cartridge before every test ensuring error free results
- ◆ **Wide Measuring Range (4-15%)**

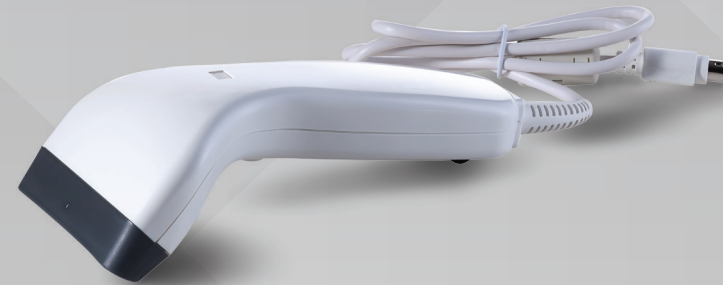

## HASSLE-FREE TESTING

- ◆ **Ready to use Cartridge**
  - No manual mixing of reagents
  - Avoid procedural errors & wastage
- ◆ **Test with Whole Blood (4µl sample) using Innovative Blood collector**
  - No special accessories / trained technician necessary for blood collection & sample processing
  - Allows easy sampling & testing
- ◆ **Results in 4 mins**
  - Test & treat in the same visit
- ◆ **Cartridges stable at Room temperature for 90 days**
  - Ease of transportation & storage
  - Minimizes temperature related errors in results
- ◆ **No daily maintenance - No hidden cost**

